

# FLEURY NEIGHBORHOOD AREA TRAFFIC MEETING

JANUARY 21, 2009

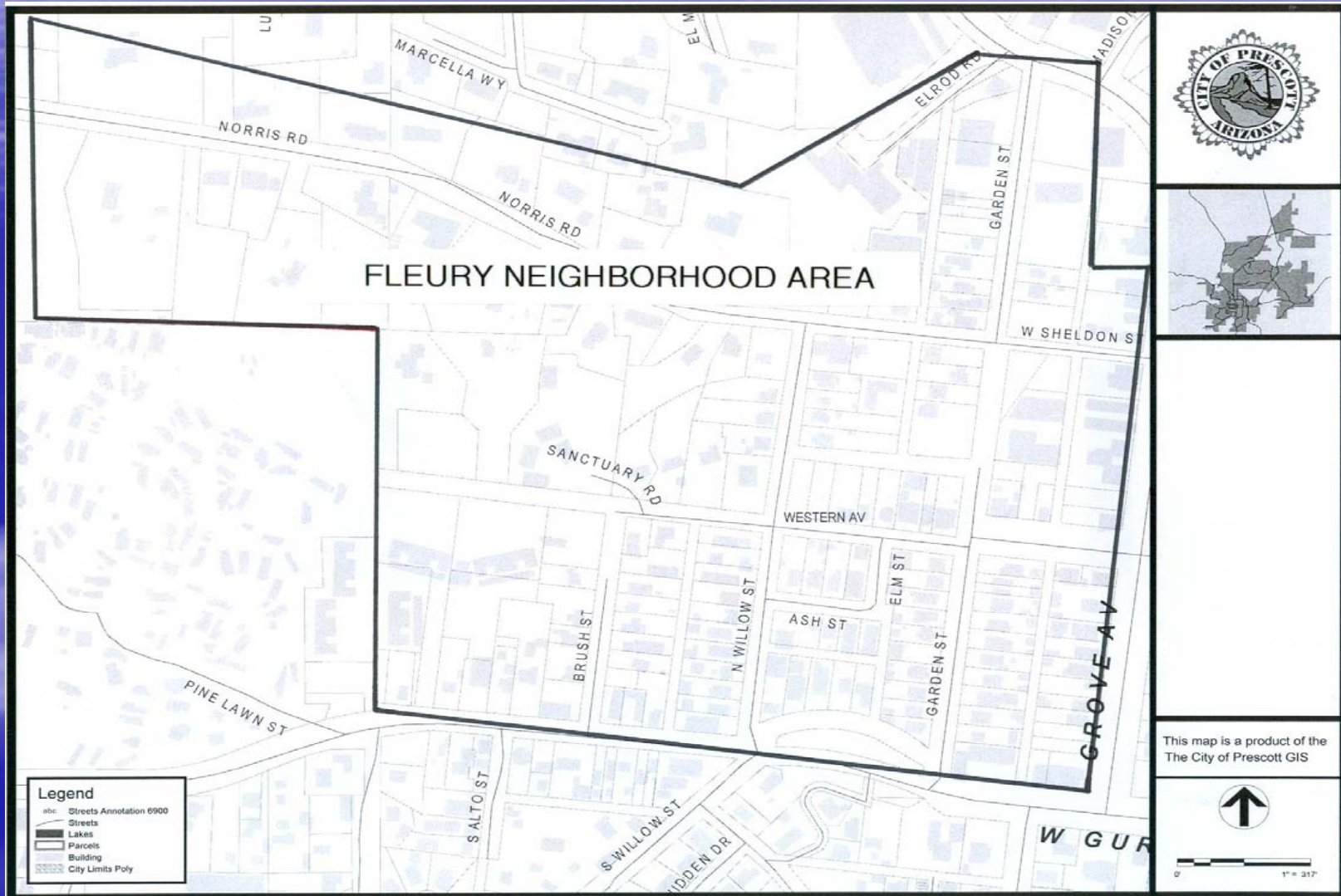

# Location Map



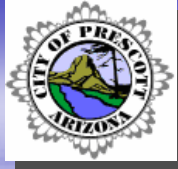

# Topics for discussion

- Provide background on the recent changes at Prescott College, specifically the alley closure, and understand how that impacts area traffic.
- Discuss the history of the road closure on Garden Street and the barrier on Willow Street.
- Provide information on current traffic patterns and highlight important issues regarding local traffic circulation and management.
- Decide on and assemble a small group of stakeholders to form a working group to formulate solutions.
- Identify specific locations and issues of traffic concern within the neighborhood using comment forms and aerials.

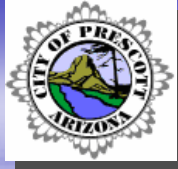

# Background

- Prescott College alley abandoned and planned for closure by Council action at Dec. 9<sup>th</sup> 2008 meeting.
- Neighborhood concerned over the loss of access to signal using alley.
- Local roadways seen as unable to safely and effectively handle the diverted traffic by some residents.
- Local spot improvements being completed by the City.

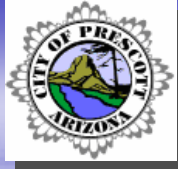

# Background

- Garden Street discussed for re-opening as an alternative to alley.
- Willow Street barrier discussed for removal.
- Concerns over major changes in the roadway network and its impacts on cut through traffic was raised.
- Neighborhood meetings recommended to discuss resident concerns and any proposed changes effecting traffic.

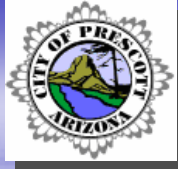

# Garden Street Closure History

- Garden Street closed by Council action in 1996.
- Requested by area residents through petition.
- Intended to alleviate recurring maintenance of creek crossing and to allow re-vegetation to a natural state.
- Daily Traffic volume of 275 cars prior to closure.

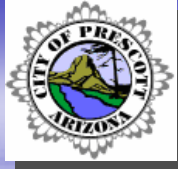

# Willow Street barrier History

- Willow Street barrier installed by Council action in 1999.
- Requested by area residents through petition.
- Intended to eliminate cut through traffic bypassing the signals at Gurley/Grove & Park and Grove/Sheldon.
- Daily Traffic volume of 1300 cars prior to closure.

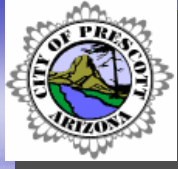

# Traffic Engineering Report Summary

- The speeds recorded in the area are typical for their classification and do not indicate a problem.
- The traffic volumes on Western, Willow and Norris/Sheldon are within the normal limits for local residential streets.
- There are alternate routes for traffic to access the signal at Gurley Street and Sheldon Street, if desired.
- Existing sight distance limitations noted at several intersections in the neighborhood are being resolved by City crews with simple maintenance of trees and shrubs and the installation of some spot improvements.
- The area roadway network is capable of handling the existing and diverted traffic without the alley, with no significant effect on traffic safety.

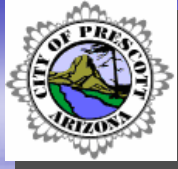

# Traffic Patterns and Issues

- The current volumes and speeds indicate an area that is working effectively, and is limited to local area traffic.
- Re-opening Garden Street and /or removal of the barrier on Willow Street is expected to have a significant impact on area traffic patterns.
- The proposed changes are likely to increase overall use of the area by outside traffic, with cut through traffic anticipated to increase substantially.
- These new movements would negatively impact the intersection of Garden Street and Miller Valley Road.
- Stakeholders should carefully weight the pros and cons of any changes.



# Working Group Formation

- Small group of 6-9 stakeholders working to resolve the traffic concerns identified through this meeting.
- Recommended group membership:
  - 1-2 Transportation Coordinating Committee representatives
  - 2 City staff representatives
  - 1-2 Prescott College representatives
  - 2-3 Neighborhood representatives
- Group will meet several times as needed to discuss traffic concern resolution.
- Group will present recommendations to area stakeholders at a second future public meeting for review and input.
- Recommendations should address the majority of stakeholder concerns, be fiscally responsible and feasible, and have City approval.
- Final approval shall rest with the City Council.

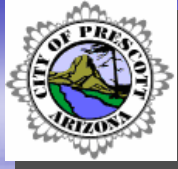

# Identify Traffic Issues and Concerns

Use provided comment sheets and aerials to highlight specific locations and issues of traffic concerns, including:

1. Roadway issues
2. Driver behavior and patterns
3. Sight distance concerns
4. Other issues.

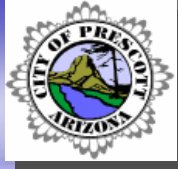

# Thanks for your Interest

- Review the provided aerials and mark locations of concern.
- Fill out comment sheets and return to front table.
- Sign up for working group at front table.